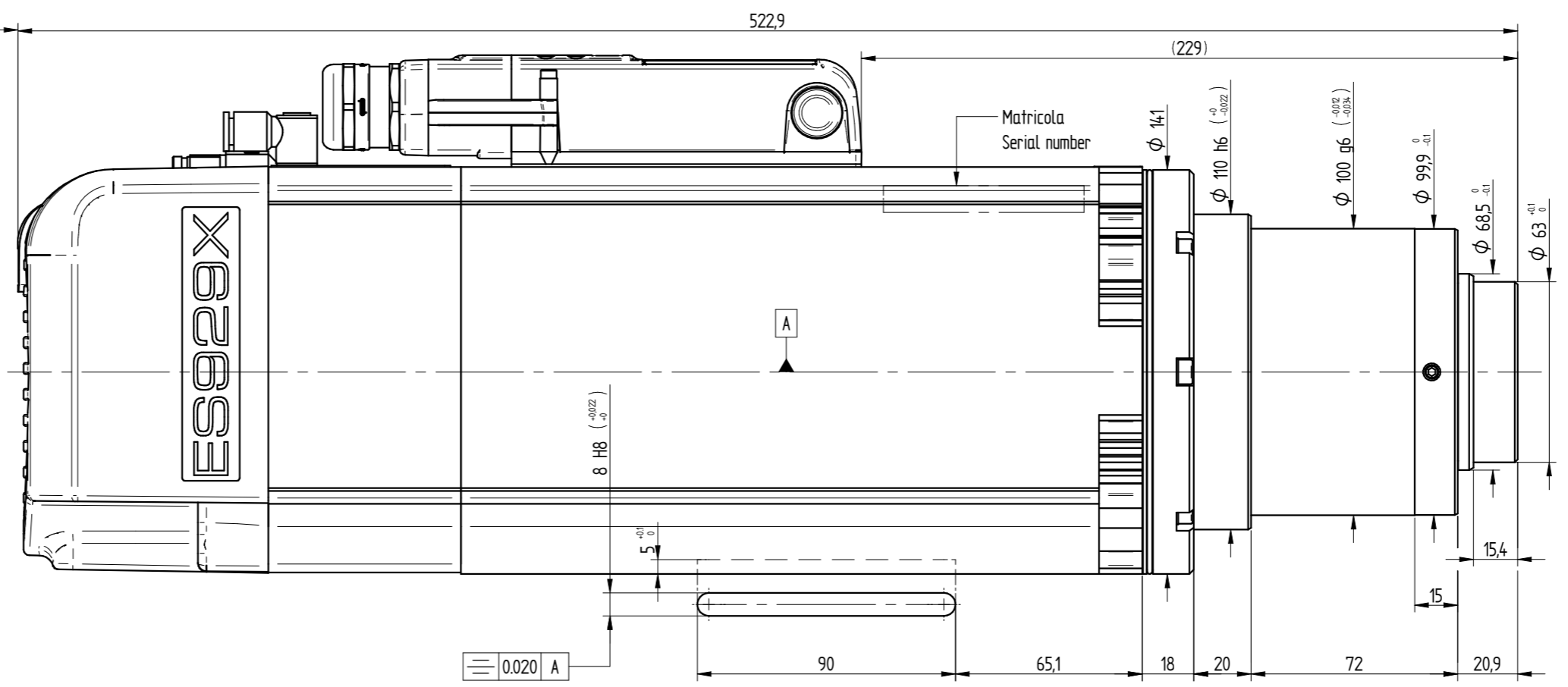
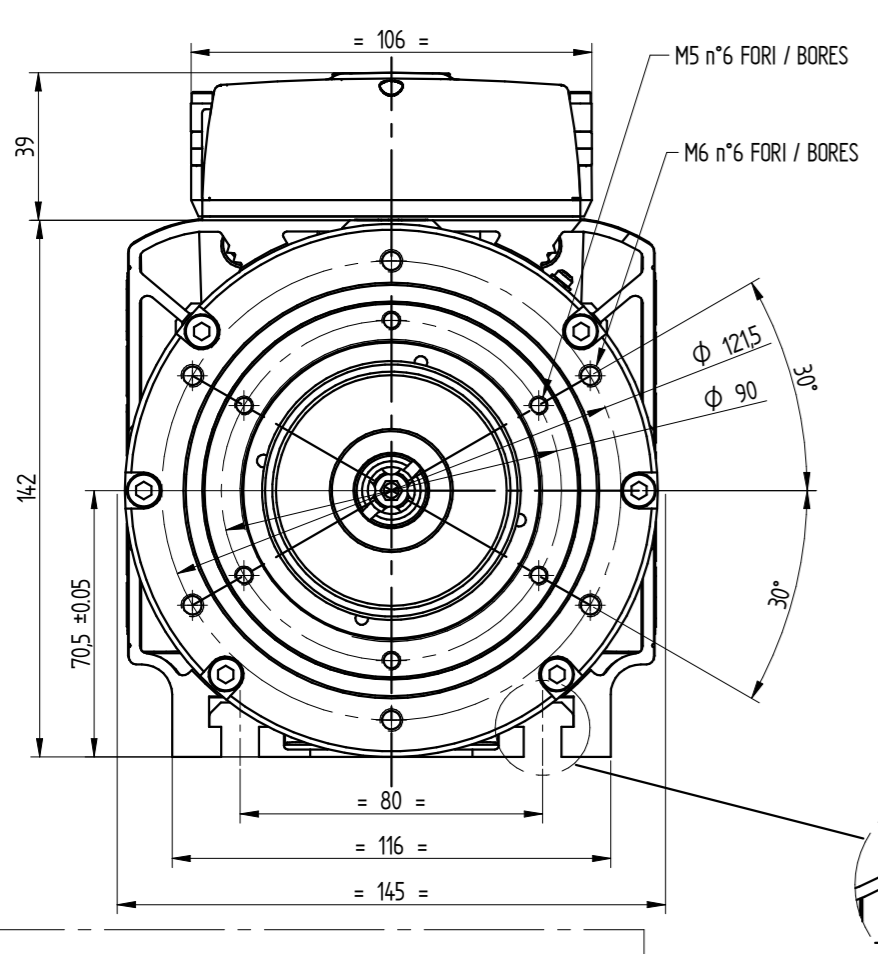

TABLE 1 DATASHEET	
TOOL-HOLDER TYPE	ISO30
WEIGHT	~ 30 kg
ROTATION	Clockwise and Counterclockwise
ROTOR INERTIA	4 e <sup>-3</sup> kg·m <sup>2</sup>
BEARINGS LUBRICATION	GREASE / GRASSO
MOTOR COOLANT	ELECTRIC FAN
TOOL BALANCING LEVEL	G 2.5
MOTOR TYPE	Three-phase Asynchronous Asincrono trifase
RATED POWER	7.5 kW
RATED TORQUE	6 Nm
RATED VOLTAGE	380 V
RATED CURRENT	14.3 A
RATED SPEED	12'000 RPM
MAX SPEED	24'000 RPM
EFFICIENCY	0.8
POWER FACTOR	0.8
POLES NUMBER	4
INSULATION CLASS	F
INDEX PROTECTION	54
ENCODER	NO



### SIGNALS CONNECTION

PIN	DESCRIPTION
1*	OUTPUT S2 (tool unlocked)
2*	OUTPUT S1+S4+S5 (tool locked)
3*	OUTPUT speed signal
4	+24V DC sensors (1A max)
6	0V DC sensors
9#	MAINTENANCE CHANNEL 1
10#	MAINTENANCE CHANNEL 2
13#	MAINTENANCE CHANNEL 3
16	Shield
17*	NC
18*	ELECTRIC FAN
19*	ELECTRONICS WORKING
20*	OUTPUT no tool
21*	Motor thermal alarm (0/24V DC)

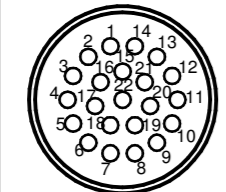
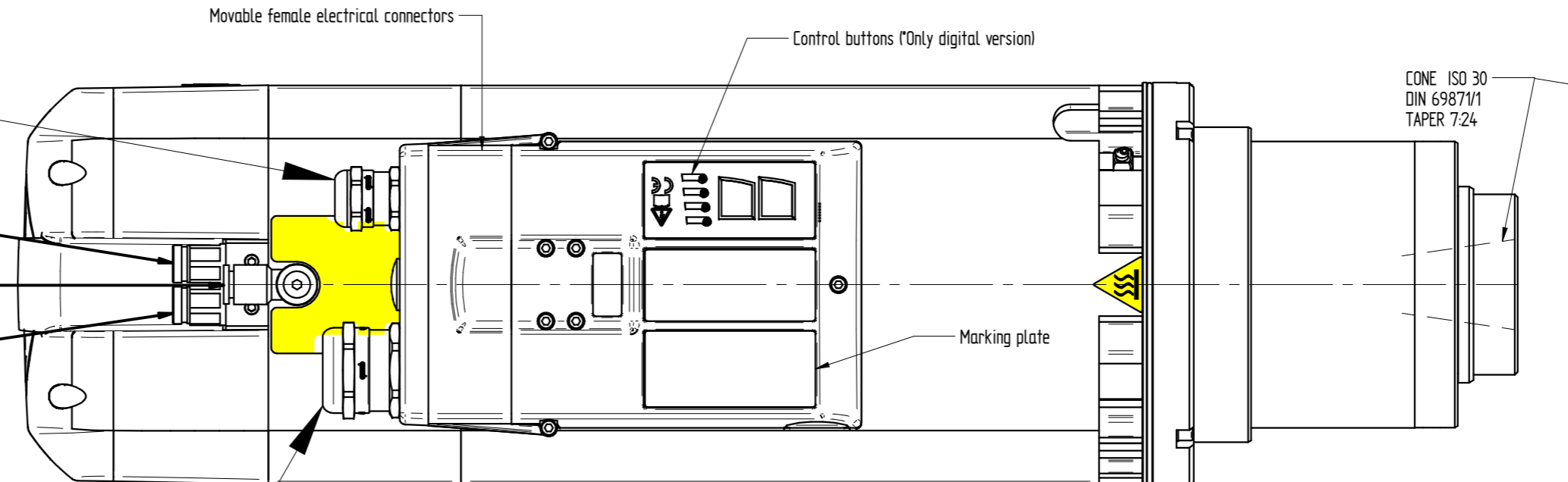
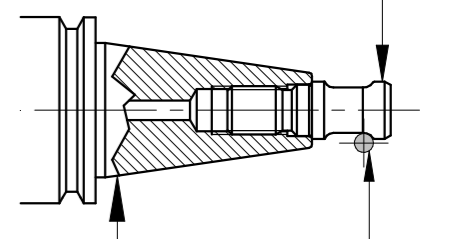

TABLE 3	
DESCRIPTION	NOTE
SPINDLE PRESSURIZATION - CONE CLEANING	Ø 8mm - 4÷5 bar
TOOLHOLDER LOCKING	Ø 8mm - 6÷7 bar
AIR INLET	
TOOLHOLDER RELEASE	Ø 8mm - 6÷7 bar
AIR INLET	



Only use pull studs designed by HSD Cod. H0804H0009



Clamp's ball  
TAPER ISO30

NOTE: if not indicated above, refer to standard DIN 69871.

### TABLE 2

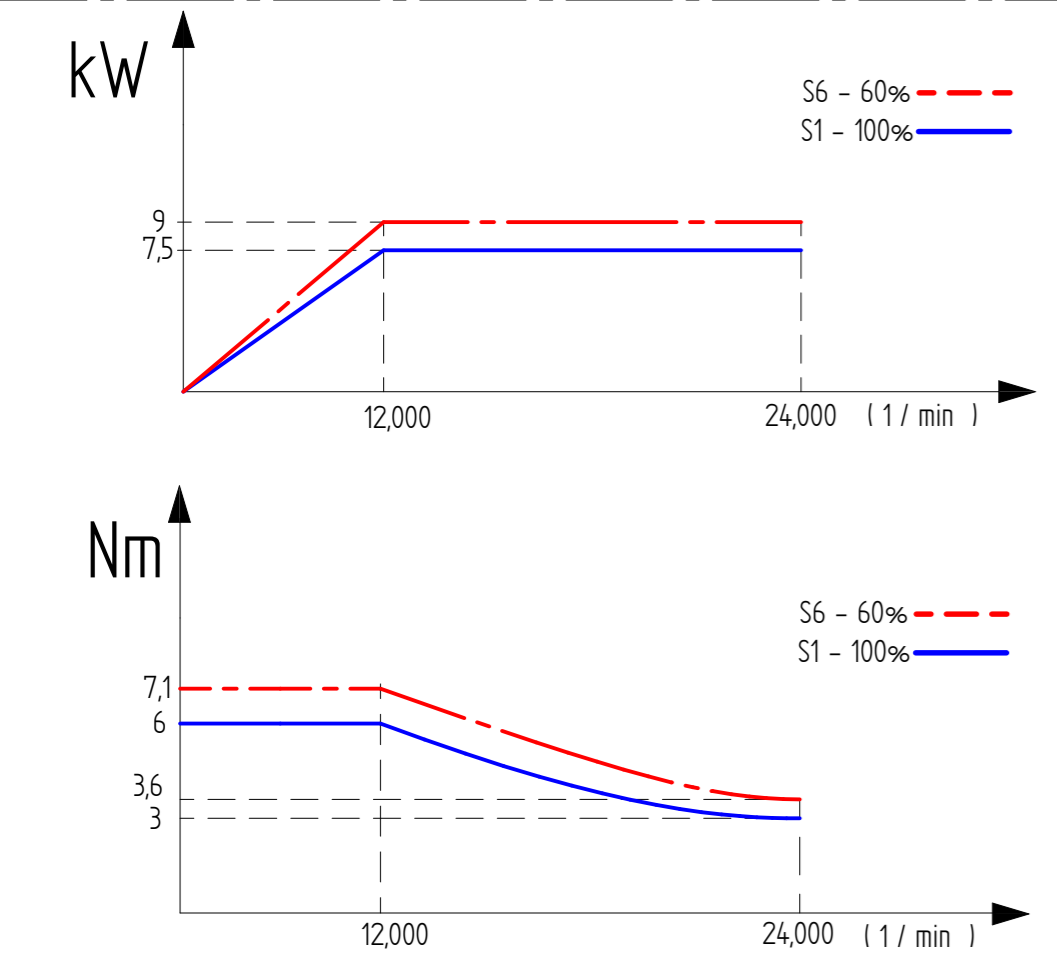

### POWER CONNECTION

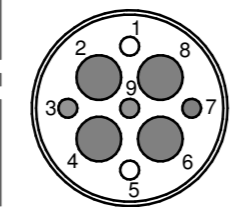

PIN	DESCRIPTION
1	Not used
2	GROUND in common with PIN7
3	Electric fan (1A max)
4	U Motor Phase
5	Not used
6	V Motor Phase
7	Shield power cable in common with PIN2
8	W Motor Phase
9	0V DC Electric fan

Always check manual before use.

ASYNCHRONOUS 3-PHASE MOTOR				Ta: 20°C
V	380	380	380	Poles: 4
Hz	400	734	800	cosφ = 0,8
rpm	12000	22000	24000	η = 0,8
kW	7,5 (9)	7,5 (9)	7,5 (9)	IP 54
A	14,3 (17)	13 (15,7)	13 (15,7)	INS.CL. F

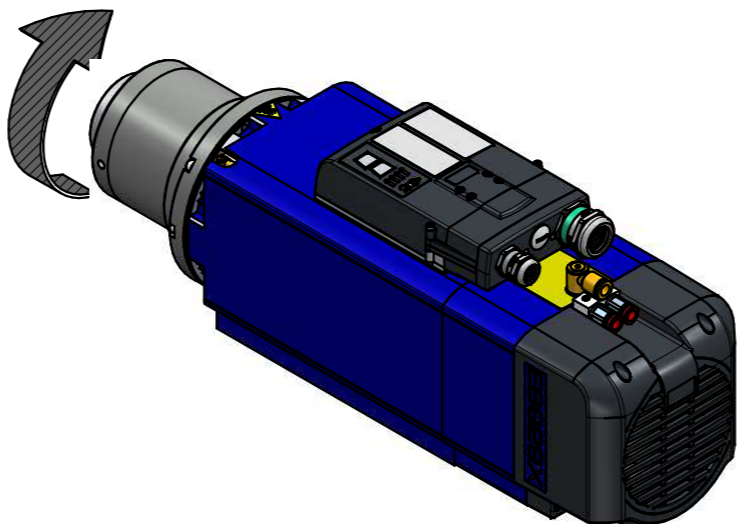

**SPINDLE ROTATION**  
Feeding the spindle in this way:  
U (0°)  
V (120°)  
W (240°)  
Verify a clockwise rotation of the shaft seen from the back of the electrospindle

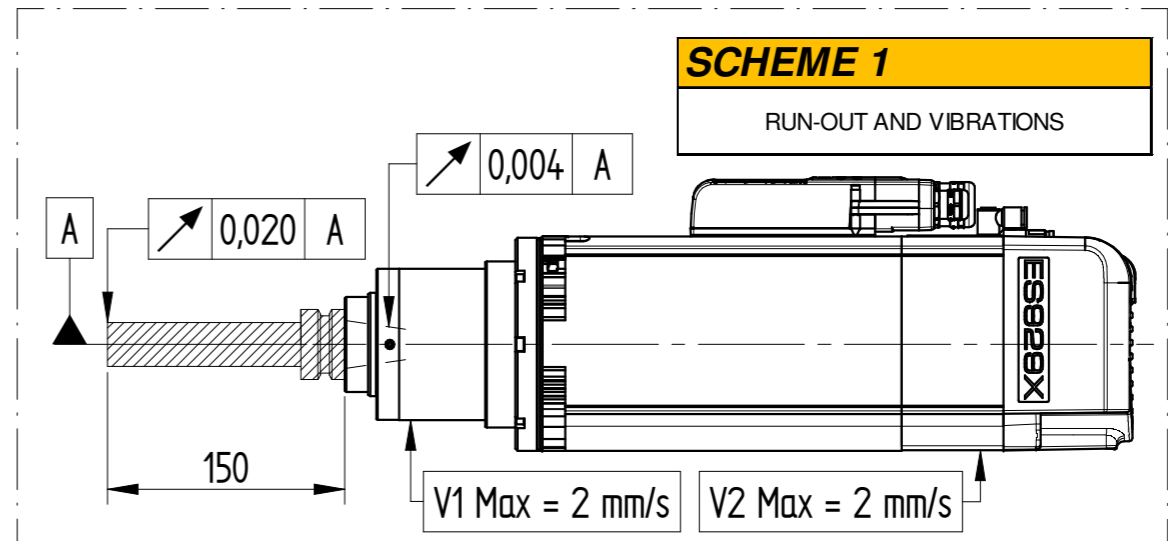

### TABLE 4

**WARM-UP**  
When starting-up the electrospindle for the first time each day, allow it to run a short warm-up cycle:  
· 50% maximum rated speed for 2 minutes  
· 75% maximum rated speed for 2 minutes  
· 100% maximum rated speed for 1 minutes

**TOOL**  
At the maximum rated speed of the electrospindle, the tools must have a dynamic balance quality grade G = 2.5 or better (standard ISO1940).  
**Respect the maximum revolutions per minute (rpm) indicated by the tool manufacturer.**

**ATTENTION:**  
FOR THE PROPER USE OF THE ELECTROSPINDLE REFERENCE IS MADE TO USER MANUAL

**SUPPLIED:**  
Female connectors

PO	PRIMA EMISSIONE PROTOTIPALE			13/03/2020	<b>HSD</b>
0	First Production submission			17/06/2020	FIRMA / SIGN: A. Pennacchio
REV.	DESCRIZIONE REVISIONE / REVISION DESCRIPTION	N°	N° CR	DATA / DATE	STATUS: Production A2
	DESIGNATO / DRAWN BY	CONTROLLATO / CHECKED BY	APPROVATO / APPROVED BY	PESO / WEIGHT: ~ 30 kg	SCALA / SCALE: 1:2
	DATA DATE	13/03/2020	13/03/2020	17/06/2020	FOGLIO / SHEET: 1 / 1
	FIRMA SIGN	A. Pennacchio	S. Memoli	G. Grosso	QUOTE SENZA INDICAZIONE DI TOLLERANZA DIMENSIONI WITHOUT TOLERANCE INDICATIONS
	MATERIALE / MATERIAL:				· SALDOCARPENTERIE / WELDED STRUCTURES:
	TRATTAMENTO TERMICO / HEAT TREATMENT:				· GETTI - ESTRUSI - STAMPATI / CASTINGS - EXTRUDED / MOULDED:
	RIVESTIMENTO SUPERFICIALE / SURFACE TREATMENT:				· CICLO DI VERNICIATURA / PAINTING CYCLE:
	DENOMINAZIONE / DESCRIPTION:				
ES929X Air ISO3 Long Nose 7.5 kW Digital					CODE CODE: H6161H2145